

Preparing the SV8W

Steam Operation:

1. Plug cable into a wall outlet.
NOTE: Do NOT use multi-outlet power-boards and avoid using low-quality extension cables.
2. Open water tank filler cap (iii), fill tank with clean tap water up to the top then close filler cap.
NOTE: Do NOT use de-mineralised water and do NOT fill with any chemicals.
3. Turn SV8W on using the ON/OFF switch (i), making sure the steam level lights on the display (g) light up after a few seconds.
4. Connect hose into the SV8W by opening the protective plastic flap located on the front of the machine (ii) and pushing the plug end of the hose in with the round red button on the top side of the hose until it clicks.

Proceed to "Vacuum Operation" and/or "Water Injection Operation" section if you are planning on using the vacuum and/or water injection functions together with the steam functions.

Vacuum Operation:

1. Turn the vacuum on from the hose controls by quick-pressing (V).

The SV8W will make a beeping noise and the vacuum waste tank lights (b) will flash on the display.

2. Open the transparent vacuum cover (iv), remove blue foam filter and slowly fill clean tap water into the rectangular hole on top of the vacuum waste tank until the vacuum waste tank lights (b) stops flashing.

3. Replace the blue foam filter and the transparent vacuum cover (iv).

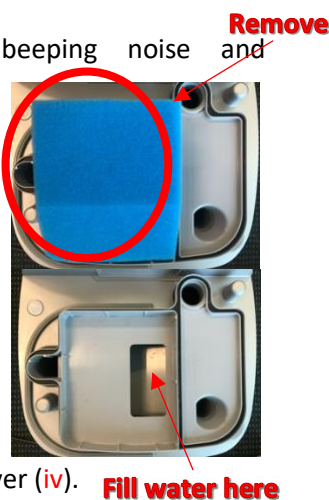

NOTE: If the vacuum waste tank lights (b) still flashes after filling the tank up, remove the plastic part with the rectangular hole, then remove the plastic divider underneath. You will see a white float, make sure the white float's surrounding areas and the float itself is clean and can move freely. Re-assemble the waste tank, fill the tank with clean tap water until the vacuum waste tank lights (b) stops flashing then put the blue foam filter and transparent vacuum cover (iv) back on.



Check the float

Hose Handle Operations

Steam Functions:

1. After 5-6 minutes the 'Steam Ready' lights (d) will light up on the display and the steam function is ready for use. Make sure the steam level lights (g) is on, otherwise quick-press the RED steam button (S) until the steam level lights turn on to prepare the steam function for use.
2. If the SV8W makes a beeping noise and the 'Low Water' lights (c) flashes, proceed to Step 2 of "Preparing the SV8W | Steam Operations".
3. Press and hold the RED steam button (S) to select between 3 steam levels: low, medium, or high. The steam level lights (g) display will light up in correspondence to the different steam levels: **1** = Low, **2** = Medium and **3** = High.
4. Once you have selected which steam levels you want, press the trigger located underneath the hose handle (T) to release steam from the nozzle.

WARNING: Do NOT operate hose with steam nozzle pointing at persons, animals or electrical machinery /equipment/outlets/sensors that are sensitive to water and heat (especially near fire alarm sensors).

Vacuum Functions:

1. Press the BLACK & WHITE vacuum button (V) to engage the vacuum function. The vacuum will turn on and you will feel suction from the vacuum nozzle.
2. If the vacuum stops, a beeping noise is heard and the vacuum waste tank lights (b) flashes, check for any water present in the waste tank. Remove any water present and proceed to Step 2 & 3 of “Preparing the SV8W | Vacuum Operations” (page 1).
3. Press and hold the BLACK & WHITE vacuum button (V) to select 3 vacuum levels: low, medium, or high. The vacuum level lights display will light up in correspondence to the different vacuum levels: **1** = Low, **2** = Medium and **3** = High.

Water Injection Functions:

1. The water injection function only works when the steam function is active. Water gets injected together with steam when it is activated.
2. To activate the water injection, press the BLUE water injection (L) button on the hose. The water injection light (e) will light up on the display.
3. If the SV8W makes a beeping noise and the ‘Water tank low’ light (c) flashes on the display, proceed to Step 2 of “Preparing the SV8W | Steam Operations”(page 1).

NOTE: Using the water injection continuously will quickly drain the water tank, therefore it is advised that the water injection function is to be used only when cleaning hard to remove stained areas.

Warning Lights

The SV8W will make a beeping noise and a red light will flash on certain conditions:

- Water tank low level (c)
- Vacuum waste tank no water/too much waste (b)



For water tank low level, refer to Step 2 of “Preparing the SV8W | Steam Operations”.

For vacuum waste tank issues, clean out the waste tank and proceed to Step 2 & 3 of “Preparing the SV8W | Vacuum Operations”.

Cleaning the SV8W

Draining the SV8W’s boiler once a month ensures that the machine operates at optimal conditions.

WARNING: Ensure machine has cooled down before attempting to clean out the boiler by checking that the machine does not feel warm on the bottom part and machine is free from any pressure.

You will need:

- A pan or container that can hold at least 5L of water
- A rag
- Flathead screwdriver
- Supplied socket wrench

1. Ensure the machine is not plugged into a power source and the machine does not feel warm with no pressure present.
2. Using a flathead screwdriver, remove the black plastic cover concealing the boiler drain plug located underneath the SV8W by inserting the screwdriver into the slit and turning counter clockwise.
3. Once the brass boiler plug is exposed, prepare the SV8W by positioning it on top of a pan or container.
4. Using the supplied socket wrench, unscrew the boiler plug by slowly turning counter clockwise. You may need to use a rag to hold the plug as you unscrew the plug by hand after loosening using the socket wrench. Let the water drain, then screw the plug back on and tighten with supplied socket wrench.

