



SV8D + SV8W

STEAM, VACUUM &
DETERGENT INJECTION

STEAM, VACUUM &
WATER INJECTION

ACCESSORIES GUIDE



PRODUCT DESCRIPTION, SAFETY & MAINTENANCE

SV8 STEAM & VACUUM MACHINES

The SV8 range includes the best featured light commercial steam and vacuum machines on the market. The SV8D and SV8W boast a huge 8 Bar of steam pressure with simultaneous adjustable steam output, and adjustable vacuum capabilities. The SV8D has the ability to inject detergent down the steam line to assist in built up dirt and grime on hard and soft surfaces. The SV8W features a water injection function, allowing you to increase the volume of water present facilitating a sanitise and rinse process - particularly suited for soft surfaces. The SV8 permits cleaning and sanitising without the need to use chemicals, ensuring a professional level clean every time across a wide range of industries.

Steam cleaning is hygienic and helps us reduce our water and chemical consumption making us more environmentally responsible. High temperature dry steam removes dirt and kills bacteria including dust mites, mould, bed bugs and other pathogens. It can be used on many different of surfaces including: ceramic floor tiles, stone floors, parquet flooring, vinyl floors, carpets, rugs, wooden ceilings, wall paper, windows, mirrors, sanitary ware, taps, cooking surfaces, ovens, grills, radiators, window and door frames, furniture, fireplaces, cars, seats etc. Steam can be generated continuously by topping up the water tank when required.

Dry Steam Cleaning is different to traditional cleaning methods. The SV8 produces steam at over 170° in the boiler, this temperature drops off to around 130° at the nozzle allowing to kill up to 99.999% of bacteria and viral agents including mould, dust mites and bed bugs. Only using minimal water, this superheated dry steam has a moisture content of only 5%. This allows to deep clean below the surface and effectively lift built up dirt and grime while sanitising surfaces and reduces the amount of "elbow grease" required.

SAFETY PRECAUTIONS

Carefully read all the safety warnings and precautions in the User Manual before operation as they provide important information for the safe assembly, use and maintenance of the steam generator. This appliance must only be used in accordance with the instructions as stated in the User Manual.

The steam stream produced by the steam machine is incredibly hot, over 100°. It is important to understand that this machine produces dry steam. This means the temperature drops off dramatically from the nozzle. To sanitise surfaces you must have contact with the surface within 5-10cm range of the nozzle. You can pass your hand safely through the steam stream a 30cm distance as the steam is then cold and therefore ineffective.

101 Degreaser: Steam Australia's 101 Degreaser is heat safe and biodegradable. This is the ONLY degreaser that can be used inside the **SV8D** machine, via the detergent tank.

ACCESSORY MAINTENANCE

It is recommended that you visually inspect your accessories prior to use. It is important to ensure that your hose and accessories are all in good condition before use. You should ensure all locking clips are undamaged, the flexible hose is in good condition and all O-rings are present. O-rings can be found on some accessories, all extensions and both ends of the hose. If you notice steam leaking from some accessories, check the O-rings from the area where the hose/accessories connection leaks steam. Replace the O-rings if needed.



COMPONENTS

1. Transparent Cover
2. Carry Handle
3. Water Tank Cap
4. Wheels
5. Display Lights
6. Mains ON/OFF Switch
7. Steam Hose Socket
- A. SV8D: Detergent Tank Cap (under transparent cover)

ACCESSORIES GUIDE

SV8D & SV8W



PRODUCT CODE		PRODUCT DESCRIPTION		PRODUCT CODE		PRODUCT DESCRIPTION	
Included Accessories		Included Accessories		Optional Accessories		Optional Accessories	
1	AC8000135	Hose S/V/D 2.5m	-	AC8000411	Trolley SV8 Grey no bottle		
2	AE0000011	Extension Tubes S/V 500mm	-	AC8000140	Hose S/V/D 5m		
3	AC8000034	Floor Tool S/V 300mm	22	AC8000045	Hose S/O suits S/V 2.5m		
4	AC8000025	Insert Dual Squeegee 300mm	-	AC8000043	Hose S/O suits S/V 5m		
5	AC0000012	Insert Carpet Glider 300mm	23	AC8000067	Upholstery Tool 110mm		
6	AC8000026	Insert Bristled 300mm	24	AC8000041	Adapter S/V to S/O		
7	AC8000027	Suction Tool S/V 150mm	25	AC8000065	S/O Aluminium Long Nozzle		
8	AC8000029	Insert Window Squeegee 150mm	26	AC8000061	Triangle Brush Red Bristles		
9	AC8000030	Insert Bristled 150mm	27	AC0030002	Triangular Cushion		
10	AC8000028	Insert Window Squeegee 250mm	28	AC8000005	Brush Rectangular S/O Floor 300mm		
11	AC0020004	Microfibre Sockette Small	29	AC0030001	Cushion Rectangular 300mm White		
12	AC8000023	Nozzle S/V Detail	-	AC0020005	Microfibre Sockette Large		
13	AC8000024	Nozzle S/V Detail w/ Extension	30	AC8000004	Plunger		
14	AC0050001	Nozzle Vac Horizontal	31	AC0000021	Weed Killer Bell		
15	AC0050002	Nozzle Vac Vertical	32	AC8000040	Mop Head Wall 250mm		
16	AC0000009	Scraper	33	AC0020001	Microfibre Mop Pad Wall 250mm		
17	AC0010022	Brush Round Nylon 30mm	34	AC8000016	Mop Head Floor 390mm		
18	Ac0010023	Brush Round Stainless Steel 30mm	35	AC0020012	Microfibre Mop Pad Floor 390mm		
19	AC0010001	Brush Round Nylon 60mm	36	AC0010020	Brush Round Brass 30mm		
20	AI0000019	Bottle with Non-Spill Cap 800ml	-	AC0010024	Brush Round Brass 38mm		
21	AC0000003	Anti-limestone Spray 50ml	37	AC0010025	Brush Round Stainless Steel 38mm		
-	TO3300002	Tool Boiler Drain Nut	38	AC0010021	Brush Round Nylon 38mm		
			39	AC0010021	Microfibre Cloth 5 Pack		
			40	Microfibre 5 Pk	Disposable Microfibre 50 Box/Carton 12x50		
			41	SA315BOX/SA315	Disposable Microfibre 20 Pack/Carton 28x20		
			42	SA315-20PKT/SA315-20	Disposable Microfibre Floor Pad 4x25pk		
			43	SA318	Steam Australia Accessories Bag		
			44	Bag-Accessories	101A 1L Degreaser Concentrate		
			45	101A	101B 5L Degreaser Concentrate		
			46	101B	101D 15L Degreaser Concentrate		
				101D			

TOOLS REQUIRED



AE0000011



AC8000034



AC8000025
SQUEEGEE INSERT



AC8000012
CARPET GLIDER

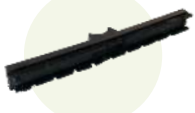

AC8000026
BRISTLES INSERT



AC0020005

FLOOR TOOL

INCLUDED

For hard surfaces such as:

- Tiles
- Marble
- Most sealed hardwood
- Linoleum & Vinyl - Carpets
- Non-slip surfaces

For sanitising soft surfaces such as:

- Carpet
- Mattresses
- Upholstery

The S/V Floor tool is a multi purpose tool with multiple inserts for cleaning a range of surfaces. Simply rotate the grey dials to lock and unlock tool. For most hard floor areas, the squeegee insert is recommended. This allows for easy vacuuming on hard surfaces such as, tiles and grout, non slip surfaces, marble and concrete. For hardwood floors use the bristled insert for a softer finish. For carpeted areas, use the carpet slider.

Using the squeegee insert, firstly use high steam pressure to release dirt off the surface. This will bring dirt, oils and grime to a solution form (fig. 1 & 2). Then, disengage the steam and turn on the vacuum to vacuum the floor dry of all residue (fig. 3). Repeat where necessary.

SV8D: For tricky to remove dirt and grime, engage detergent function. This will periodically pump detergent into the steam line. Activate steam, allow detergent to pump out the desired amount, then switch off detergent injection, continue to steam then vacuum until surface is clean & almost dry. Tip: less is more with degreaser.

SV8W: Do not activate water injection function when using the floor tool unless in area with drain, such as bathroom, kitchen or outside.

When using with carpets, use carpet glider insert. Set steam to medium and vacuum level to high (fig.4).

To sanitise mattresses and upholstery you can adapt the floor tool into a steam pad by fitting the large microfibre sockette (Optional). This creates a super-heated steam pocket to effectively sanitise carpets, upholstery & mattresses (fig.5 & 6).

Caution: When switching inserts, tool may be hot. When microfibre is being used, it retains more moisture and traps the heat. This super-heated steam pocket must be used with caution. Tools will be hot after use. Best for sanitising



1.



2.



3.



4.



5.



6.

TOOLS REQUIRED



AC8000027



AC8000028



AC8000030



AC8000029



AC0020004

SUCTION TOOL

INCLUDED

For hard surfaces such as:

- Mirrors & Windows
- Car windscreen
- Tabletops & Benchtops

For soft surfaces such as:

- Upholstery
- Curtains and blinds in situ

Suction tool has interchangeable inserts, available in 150mm and 250mm squeegee, and 150mm bristled insert. This tool can be used on a range of hard and soft surfaces.

As window squeegee function:

This tool is suitable for glass surfaces including windows, shower screens and bathroom mirrors (fig. 1, 2 & 3). Attach the desired squeegee insert. Spray a stream of steam in a circular motion onto the glass surface to loosen any surface impurities. Then use the rubber squeegee blade to remove water condensation and clean the surface. Start from the top of the surfaces moving in a downward motion.

Tips: If using in areas with frosty climates, warm the windows or mirrors by spraying a high stream of steam for a slightly prolonged time before cleaning.

SV8D: Activate detergent injection if required.

As flat surface cleaner: Hard

Tool can be used on smooth surfaces such as stainless steel kitchen bench-tops and splash backs in domestic and commercial settings with squeegee inserts (fig. 4 & 5).

As flat surface cleaner: Soft

To sanitise upholstery such as lounges, curtains in situ and mattresses, attach bristled insert, use medium level steam. This tool is also suitable for doors and bench-tops.

For delicate surfaces/areas of concern we suggest using microfibre sockette. To attach, pull over bristled insert encasing the tool to ensuring no gaps for steam to escape. Using low level steam only, gently wipe across surface to sanitise (fig. 6).

Tips: Use low level steam to reduce added moisture.

Caution: Using medium - high level steam or using activated steam for a prolonged period of time will increase the amount of moisture present. It is important to exercise caution when cleaning surfaces near or above power points. It is important to be conscious of drips when cleaning mirrors, windows, range hoods and bench-tops.
Tools will be hot after use.

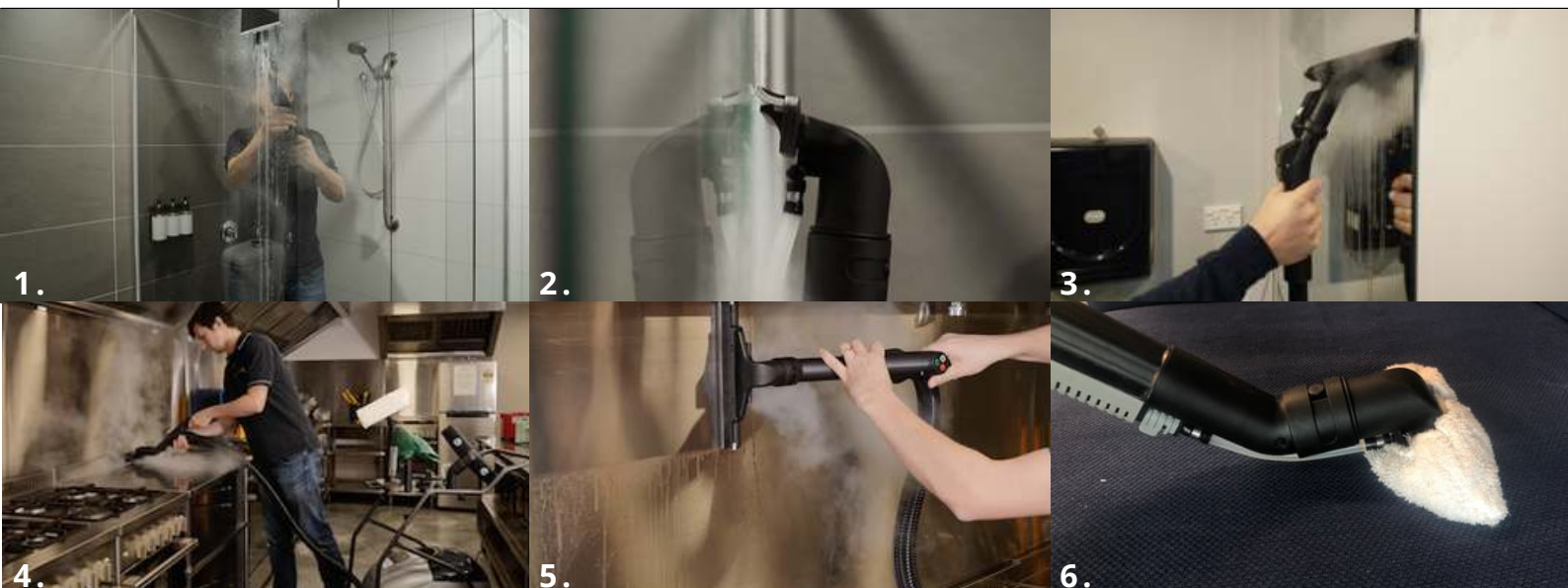

TOOLS REQUIRED



AC8000023



AC0010022 AC0010023
AC0010021 AC0010025



AC0010020 AC0010001
AC0010024



Microfibre
5 Pack AC0000009



AC0050001 AC0050002

DETAIL NOZZLE

INCLUDED

For hard surfaces such as:

- Tiles & grout
- Sinks, Taps & Drains
- Oven grease
- Toilet seat hinges and side lip
- Sliding door tracks
- Shower recess & limescale

Compatible Accessories:

- Brush Round Nylon 30mm, 38mm, 60mm
- Brush Round Brass 30mm, 38mm
- Brush Round Stainless Steel 30mm, 38mm
- Scraper
- Plunger
- Weed Killer Bell
- Vertical & Horizontal Vac Nozzles

Steam/Vac detail nozzle is a versatile tool and can run a range of attachments such as brushes, scraper, plunger, weed bell and vacuum nozzles. Tool can be used on its own for focused steam spray. Use a high quality microfibre cloth to collect residue.

For best results when cleaning grout, hold brush on angle to clean side of the grout line, and then tilt in other direction to clean the other side of the grout line (fig. 1).

Sanitise toilet lip and bowl, basins, drains and taps. Easy to access tricky spots with angled detail nozzle (fig. 2).

Circular motions and medium pressure will assist to remove baked on grease from ovens and cooktops (fig. 3 & 4) in commercial kitchens. The 38mm brush size is recommended. **Tip:** Firmly press a plastic steel wool into the brush, this can accelerate your clean with an abrasive scratch-proof surface.

Steam into hard to reach areas such as sliding door tracks. Detail nozzle can aid access to otherwise difficult to clean areas (fig. 5).

Attach vacuum nozzles to tool for complete cleaning. Using low to medium steam, target areas with nozzle, deactivate steam, change angle of tool, activate vacuum and suck up any dislodged dirt and grime. The horizontal vac tool is great for use on flat areas in particular when targeting tiles & grout (fig. 4), vertical vac tool is great for skirting boards, edges and between furniture.

Tip: Stainless steel/brass brushes can be fitted onto detail nozzle to scrub off certain hard-to-remove stains in nooks and crannies. Stainless steel is particularly effective on grout. When cleaning a new surface, always start with nylon, then progress to brass, then stainless steel. This will ensure you do not damage/scratch surfaces.

Caution: Be wary that the stainless steel and brass brushes may scratch certain surfaces, leaving unwanted scratch marks. Always test areas in an inconspicuous spot before proceeding. Tools will be hot after use.

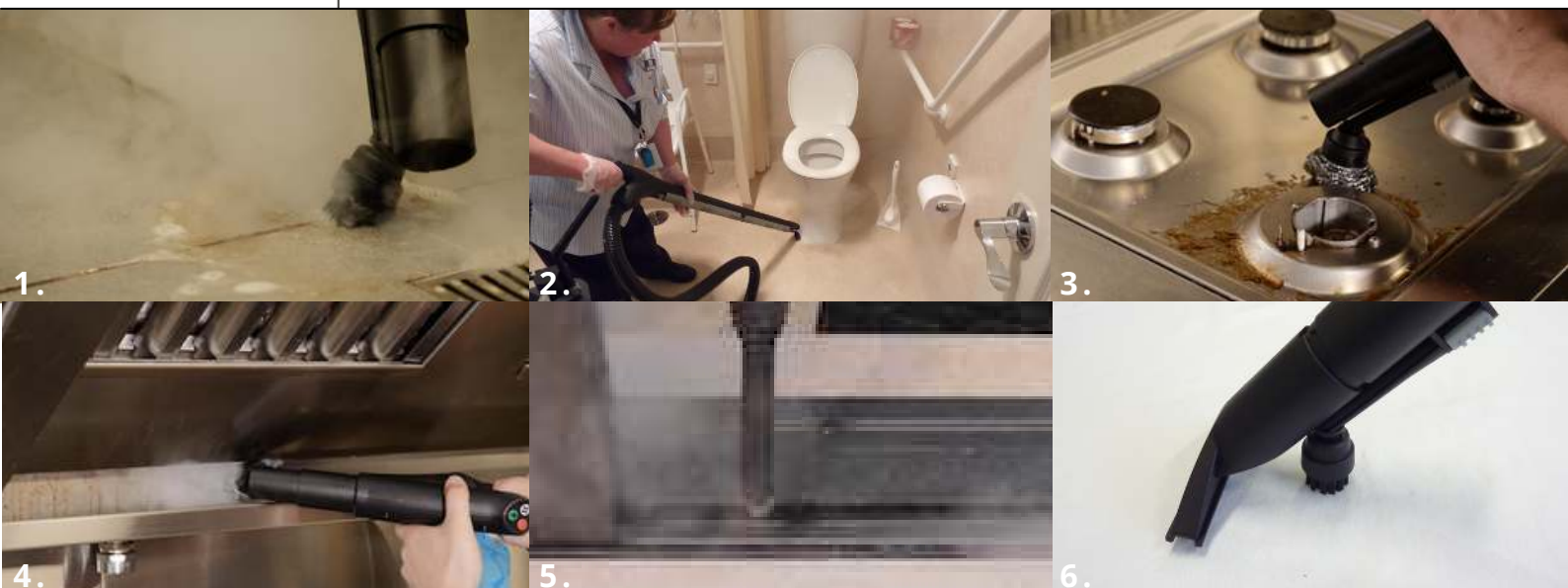

TOOLS REQUIRED



AC8000024



Microfibre
5 Pack



AC8000067

DETAIL NOZZLE W/ EXTENSION

INCLUDED

For hard surfaces such as:

- Grout lines
- Skirting boards and corner grout
- Sinks, Taps & Drains
- Toilet seat hinges and side lip
- Sliding door tracks

Steam/Vac detail nozzle w/ extension is a specified tool for hard to reach areas such as around bathroom fittings, toilet seat hinges, sanitise toilet lip and bowl, bath, basins, drains and taps. (fig. 1, 2 & 3). Use high quality microfibre to collect residue and leave surface dry.

Steam hard to reach areas such as sliding door tracks, behind & underneath furniture. Detail nozzle w/ extension can aid access to otherwise difficult to clean areas (fig. 6).

Tip: This tool should not be used with any downward pressure and brushes should not be put on the end of the nozzle as this is not a tool for brushing or scrubbing.

UPHOLSTERY TOOL

OPTIONAL

For soft surfaces such as:

- Upholstery
- Carpet spot cleaning

For deep cleaning fabric upholsteries such as sofas, office chairs, car seats, car fabric interiors and particularly affective on car carpet. Best used with the water injection function on SV8W, can be utilised with detergent feature on SV8D.

SV8D: Engage detergent function. This will periodically pump detergent into the steam line. Activate steam, allow detergent to pump out the desired amount, then switch off detergent injection, continue to steam and vacuum until surface is clean & almost dry.

Tip: It is important to note that less is more with degreaser.

SV8W: Engage the water function. Turn vacuum to high, turn steam pressure to high. Press and hold the trigger to pump additional water through the steam line while vacuuming. It is important to always have vacuum function activated when using water injected to avoid saturating surfaces. Best suited for upholstery and carpet

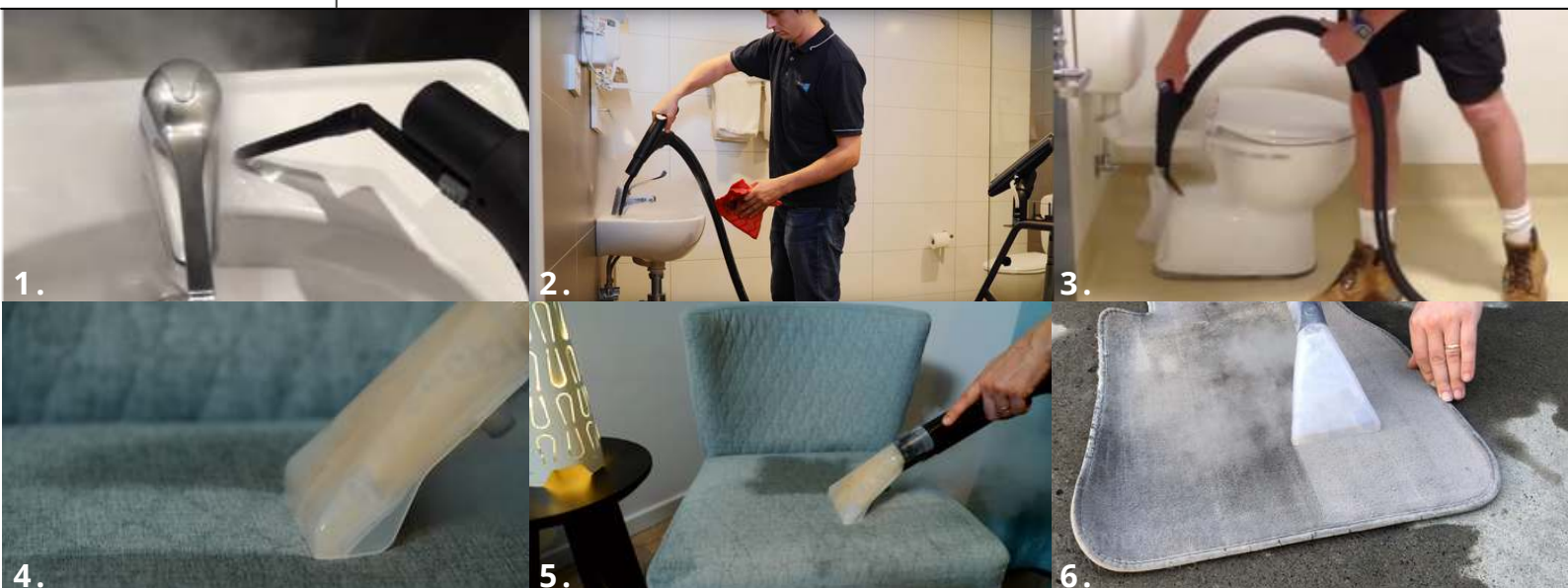

RECTANGLE FLOOR BRUSH

OPTIONAL STEAM ONLY

TOOLS REQUIRED



AC8000041



AC8000005



AC0030001



Microfibre
5 Pack

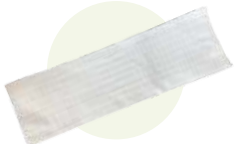

Disposable Microfibre
Floor Pad

For hard surfaces such as:

- Tiles & Grout
- Marble
- Most sealed hardwood
- Linoleum & Vinyl
- Non-slip surfaces

For sanitising soft surfaces such as:

- Carpet
- Mattresses
- Upholstery

The Rectangular Floor Brush is an excellent tool where agitation is required. The brush features a tough row of nylon bristles along the perimeter of the tool. This is a great tool for maintenance floor cleaning, where little pressure is applied with use of high quality microfibre. This brush can also be used to scrub off hard-to-remove dirt and built up grime on hard floors, mould and limescale in shower recess, moss and algae on outdoor tiles in particular around a pool, spa, or garden bed with excess moisture.

Begin with low level steam to loosen bacteria and grime, introduce light scrubbing with or without steam activated (as required). In stubborn areas use level 2 or 3 steam followed by moderate brushing (fig.1).

This tool can be fitted with microfibre cloth to be used as a steam mop with trailing microfibre to clean and sanitise floors (fig.2). Simply attach microfibre to rear clips on top of the tool. Steam surface, scrub if required, turn off steam, flip microfibre around the base of the tool to mop up residue (fig.3)

The tool can also be fitted with cushion and microfibre encasing the floor tool. This creates a superheated steam pocket to effectively sanitise carpets, upholstery, mattresses stairs and floors (fig.4 & 5). Ensure microfibre is wrapped tightly in a nappy fold and secured to the tool using the rear and front clips.

Disposable microfibre are recommended for cleaning areas such as bathroom floors or areas where infection prevention & disposal of contaminated products is required. Insert cushion, attach disposable microfibre securing to each end of the tool (fig.6).

Tips: Use low level steam only when steaming through microfibre/cushion. Use in sweeping motion reducing long exposure in one position. Patch test on sensitive surfaces.

Caution: When cushion and microfibre wrap are being used, the cushion retains more moisture and traps heat. This superheated steam pocket must be used with caution. Tools will be hot after use. Best for sanitising and killing bacteria.



TOOLS REQUIRED



AC8000041



AC8000061



AC0030002



Microfibre
5 Pack



Disposable
Microfibre

TRIANGLE BRUSH

OPTIONAL STEAM ONLY

For hard surfaces such as:

- Tiles & grout
- Skirting boards
- Corner work on walls, floors, ceilings
- Benchtops
- Range hoods
- Cupboard & under bench storage
- Shower Recess and vanity

For sanitising soft surfaces such as:

- Mattresses
- Upholstery
- Lounges and seats
- Curtains
- Car seats & car mats

The Triangle Brush is a wonderfully versatile medium sized tool. The brush features a tough row of nylon bristles along the perimeter of the tool. This is a great tool for quick surface sanitising where little pressure is applied with use of high quality microfibre. This brush can also be used to scrub off hard-to-remove dirt and built up grime in hard to reach areas such as skirting boards, range hoods, corner areas, ceilings, under bench or cupboard storage.

Begin with low level steam to loosen bacteria and grime, introduce light scrubbing with or without steam activated (as required). In stubborn areas use level 2 or 3 steam followed by moderate brushing (fig.1).

The tool can be fitted with cushion and microfibre encasing the brush. This creates a superheated steam pocket with a smooth surface to effectively sanitise a range of hard and soft surfaces such as smooth bench-tops, skirting boards, upholstery, mattresses and curtains (fig.3,4,5). Ensure microfibre is wrapped tightly in a nappy fold and secured to the tool using the clips (fig.2). The Triangle brush features a 360° pivot neck with the ability to lock into three different places (fig.2).

Disposable microfibre is recommended for cleaning areas where infection prevention and disposal of contaminated products is required such as cleaning mould. Insert cushion, attach disposable microfibre securing to the tool (fig.6). Dispose after use.

Tips: Use low level steam when steaming through microfibre/cushion. Always use in sweeping motion reducing exposure in one position. Patch test on sensitive surfaces.

Caution: When cushion and microfibre wrap are being used, the cushion retains more moisture and traps the heat. This superheated steam pocket must be used with caution. Tools will be hot after use. Best for sanitising and killing bacteria.



MICROFIBRE FOLD TECHNIQUE FOR RECTANGLE & TRIANGLE BRUSH

How to effectively wrap your rectangular floor brush and/or triangle brush with a high quality reusable or disposable microfibre cloth. This creates a superheated steam pocket with a smooth surface to effectively sanitise a range of hard and soft surfaces such as smooth benchtops, skirting boards, upholstery, mattresses and curtains.

Disposable microfibre are recommended for cleaning areas where infection prevention and disposal of contaminated products is required such as cleaning mould spores. Insert cushion, attach disposable microfibre cloth securing to the tool.

STEPS:

1. Lay microfibre flat on bench top
2. Fit tool with appropriate fitted cushion
3. Place tool on microfibre cloth
 - a. For triangle brush position slightly to left or right to ensure enough reach for nappy fold to effectively encase the tool.
4. Fold microfibre cloth across the back of the tool securing with the clips
5. Fold corner by corner, making sure all edges are secure
6. Ensure microfibre is wrapped tightly in a nappy fold and secured to the tool using the clips.
7. Where microfibre cannot fully encase tool, it is important to remember steam will leak from that area, keep fingers clear when cleaning.
8. When microfibre is saturated, remove wet cloth and replace with dry cloth.

Tips: Use low level steam only when steaming through microfibre and/or cushion. Always use in sweeping motion reducing long exposure in one position. Patch test on sensitive surfaces.

Caution: When cushion and microfibre wrap are being used, cushion retains moisture and traps heat. This superheated steam pocket must be used with caution. Tools will be hot after use. Best for sanitising surfaces and killing bacteria.

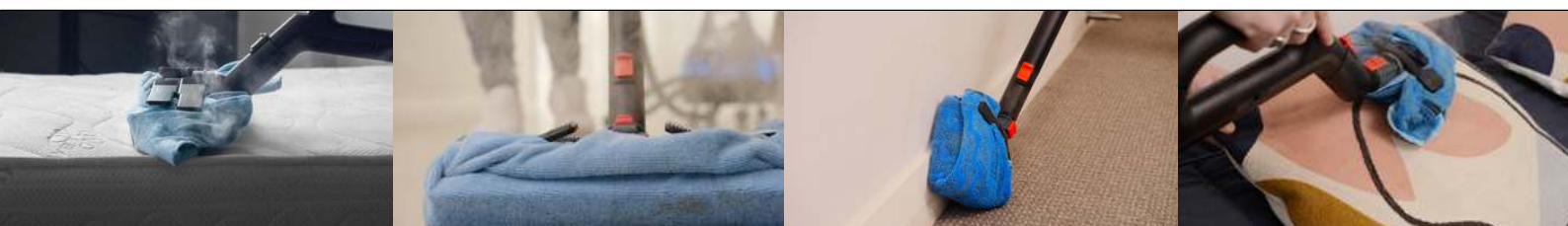

TOOLS REQUIRED



AC8000041



AC8000006



AC0010023

AC0010025



AC0010001



AC0000009

FLOOR MOP & WALL MOP HEADS

OPTIONAL STEAM ONLY

For hard surfaces such as:

- Tiles & Grout
- Marble
- Most sealed hardwood
- Linoleum & Vinyl
- Kitchen Splash-back
- Walls
- Ceilings

Steam mop head and fitted microfibre pad create a superheated steam mop pad with a smooth surface to effectively sanitise a range of hard surfaces such as benchtops, splash-backs, walls and ceilings. Ensure microfibre pad is secured correctly and tightly to the tool using the straps. The Wall & Floor Mop Heads feature a 360° pivot neck for effortless mopping and high manoeuvrability.

FLOOR MOP 390mm

For cleaning non-carpeted hard-floor surfaces. Use low steam flow and move forwards and backwards quickly over the floor surface for a sanitised surface clean. Large mop head makes for easy and quick surface sanitising on large areas. Pivot arm allows for ease of use under furniture such as tables and chairs.

WALL MOP 250mm

For hard wall surfaces and ceilings. Use low level steam for cleaning dirt, dust, marks and food stains off walls and splash-backs moving quickly over the surface. Can also be used to sanitise walls in kitchens and other areas such as cupboards & laundry ceiling.

Tools can be interchangeable but we recommend the floor tool be used for floors and wall tool be used for walls and ceiling. When lifting tools above hip height, the weight of the tool is more noticeable. If using Floor Head on walls or ceilings be cautious technique and possible back strain.

Tips: Use low level steam only when steaming through microfibre. Always use in sweeping motion reducing long exposure in one position. Surface will be left hot and slightly damp. Due to the residual heat, surfaces will dry quickly

Caution: Microfibre retains moisture and traps heat. Exercise Caution when handling or changing microfibre cloths as they retain heat and may cause burns when saturated.

Tools will be hot after use. Best for sanitising and killing bacteria.



TOOLS REQUIRED



AC8000023



AC8000004

PLUNGER

OPTIONAL

For surfaces such as:

- Kitchen sink
- Bathroom sink

Plunger accessory fits on the end of the detail nozzle. It can then be placed over a sink drain for bathroom and kitchen use. By blocking the sink, pressure builds up and pushes steam through the s-bend. This can effectively remove blockages and deodorise sink drains.

Caution: Be wary if your sink has an overflow, that steam will escape and may cause injury. Ensure the overflow is covered tightly with a material which will not heat up and burn you.

WEED KILLER BELL

OPTIONAL



AC8000023



AC0000021

For surfaces such as:

- Cracks in tiles & grout
- Stairs
- Garden Edge

Take your steam cleaner into the garden with our Weed bell attachment. Cover weed with bell ensuring centre of steam spray is directed at weed. With downward pressure and medium steam, hold down over weed for 10-15 seconds. Some weeds depending on size or type may take longer to kill. Assess the results and repeat process up to a week after first application.



TOOLS REQUIRED



AC8000041

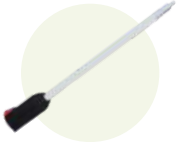

AC8000065

ALUMINIUM LONG NOZZLE

OPTIONAL STEAM ONLY

For surfaces such as:

- Engine Bay
- Wheels and Rims
- BBQ & Oven
- Vents and pipes

The Aluminium Long Nozzle can be used to access difficult to reach areas, such as engine bays, wheel rims, back of BBQ etc. This straight nozzle acts as a slim extension which can fit into narrow areas and under furniture. Can be used in drains, through grates, into range-hood and exhaust, to aid cleaning out of reach areas.

TROLLEY

OPTIONAL



AC8000411

Recommended for the following uses;

- Hospitality
 - Accommodation Venues
 - Restaurant & Bar
- Health & Aged Care
 - Hospital & Aged Care Facilities
 - Doctors & Dental
 - Physio & Chiro
- Education & Childcare

Trolley to suit SV8 has a sturdy 4 wheel base with bucket for tool. Hooks for hoses to hang make for easy tidy transport for your SV8 machine.





1300 79 50 50

208/27 Mars Rd, Lane Cove NSW 2066

info@steamaustralia.com.au

www.steamaustralia.com.au