

# Saphira C8

## QUICK START GUIDE

Make your safety a priority

### PREPARING THE SAPHIRA C8



1

Plug cable into a wall outlet.

**NOTE:** Avoid using multi-outlet power-boards and low-quality extension cables.

2

Open filler cap (i.). Fill tank with filtered or clean tap water. Close cap. **NOTE:** Do not use demineralised water. Do not add chemical.

3

Connect hose into the Saphira by opening the protective flap located on the front of the machine (ii.)

Push the plug end of the hose in, with the round red button on the top side of the hose, until it clicks.

**WARNING:** Please ensure steam handle is switched OFF before plugging into machine.

4

Turn on Saphira using the black ON/OFF switch (iii.).

5

Wait until machine reaches temperature. The green 'Steam Ready' (iv.) LED will light up on the display, indicating the Saphira is ready to use.

### DISPLAY PANEL

The Saphira is a simplified unit with two indicators.

- The green light (iv.) indicates when machine is ready to use.
- The yellow light (v.) indicates when the water reservoir is empty. Alarm will sound, and steam output will cease.

Follow step 2, 'Preparing the Saphira C8' to refill reservoir.

**NOTE:** The continuous steam capability allows for water reservoir re-filling at any time during operation. When alarm sounds, you can refill the water as required.

**WARNING:** Servicing boiler nut on underside of machine will remain HOT after machine is switched off.

1300 79 50 50

[www.steamaustralia.com.au](http://www.steamaustralia.com.au)

## STEAM OPERATION & MICROFIBRE APPLICATION

Steam levels 1-3 can be selected using the on/off switches located on the hose handle (vi.).

Level 1: Basic Steam

Level 2: Moderate Steam

Level 3: Deep Clean

**WARNING:** Do not operate hose with steam nozzle pointing at people, animals or electrical equipment/outlets that are sensitive to water and/or heat, such as fire alarm sensors.

To correctly apply the microfibre cloth to the triangle brush, follow the diagram below. Make sure the baseline of the brush is tightly wrapped to ensure steam does not leak.

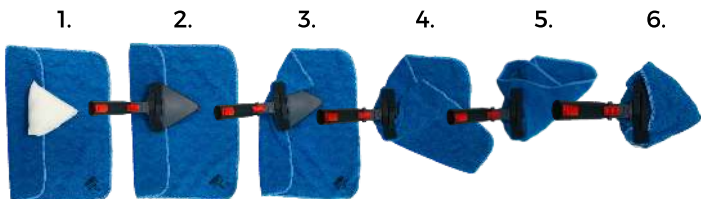

**To register your product,  
download user manuals,  
& safety data sheets**

please go to:  
[steamaustralia.com.au/support/](http://steamaustralia.com.au/support/)



1300 79 50 50

[www.steamaustralia.com.au](http://www.steamaustralia.com.au)

